**LB-340-20-C-SFSP0 Standard Gain Horn Antenna 2.2-3.3GHz 20dB Gain SMA Female**

Standard Gain Horn Antenna Operating From 2.2GHz to 3.3GHz With a Nominal 20dB Gain With SMA Female Connector

Product Information

| | |
|-----|-------------------|
| SKU | LB-340-20-C-SFSP0 |
|-----|-------------------|

Description

Standard Gain Horn Antenna LB-340-20-C-SFSP0, operating from 2.2 to 3.3GHz with a nominal 20dB gain and low VSWR 1.25:1 with SMA Female connector output. The model LB-340-20-C-SFSP0 has uniform gain through its frequency span, providing efficient performance characteristics and directionality. It can handle 50W continuously and 3000W peak power. Constructed of lightweight corrosion-resistant aluminum, the horn comes with a specially designed weatherproof radome which provides excellent protection against the rain and dust but has very little loss across the full operating frequency band. This standard gain horn antenna is linearly polarized and ideally suited for EMI testing, direction finding, surveillance, antenna gain and pattern measurements and other applications.

Technical Specification

| Electrical Specification | | Interface | |
|------------------------------------|-------------|--------------------------|---|
| Frequency, Min (GHz) | 2.2 | Output Type | Coaxial |
| Frequency, Max (GHz) | 3.3 | Connector | SMA |
| Waveguide Type | Rectangular | Connector Gender | Female |
| Waveguide Size EIA WR | WR340 | Mechanical Specification | |
| Gain, Typ (dBi) | 20 | Figure | C Type |
| Polarization | Linear | Body Material | Al |
| 3dB Beamwidth, E-Plane, Typ (Deg.) | 16 | Finish | Chemical Conversion Coating, Gray Paint |
| 3dB Beamwidth, H-Plane, Typ (Deg.) | 18 | Size, W (mm) | 506 |
| Cross Pol. Isolation, Typ (dB) | 40 | Size, H (mm) | 431 |
| VSWR, Typ | 1.25:1 | Size, L (mm) | 966 |
| Impedance, (Ohm) | 50 | Weight, (kg) | 9.4 |
| Power Handling, CW, (W) | 50 | | |
| Power Handling, Peak, (W) | 3000 | | |

Additional Information

| | | | |
|-------------|--|--------------|---|
| Application | Outdoor, Waterproof and Dustproof, Fixed | Solution for | Gain Reference Antenna Measurement Reflector Feed Far-field Measurement System Intergration Material Measurement |
|-------------|--|--------------|---|

Outline Drawing

SMA Female Output with Radome (Option, P/N: LB-340-20-C-SFSPO, Outdoor Application)

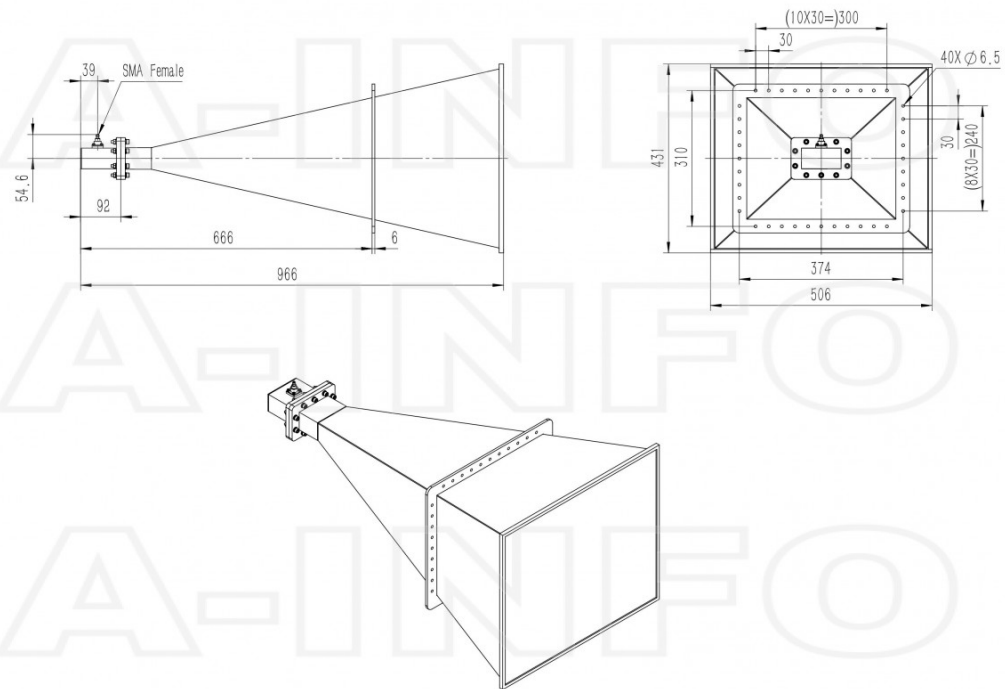

SMA Female Output with Round Mounting Bracket & Radome (Option, P/N: LB-340-20-MB2 & LB-340-20-C-SFSP0, Outdoor Application)

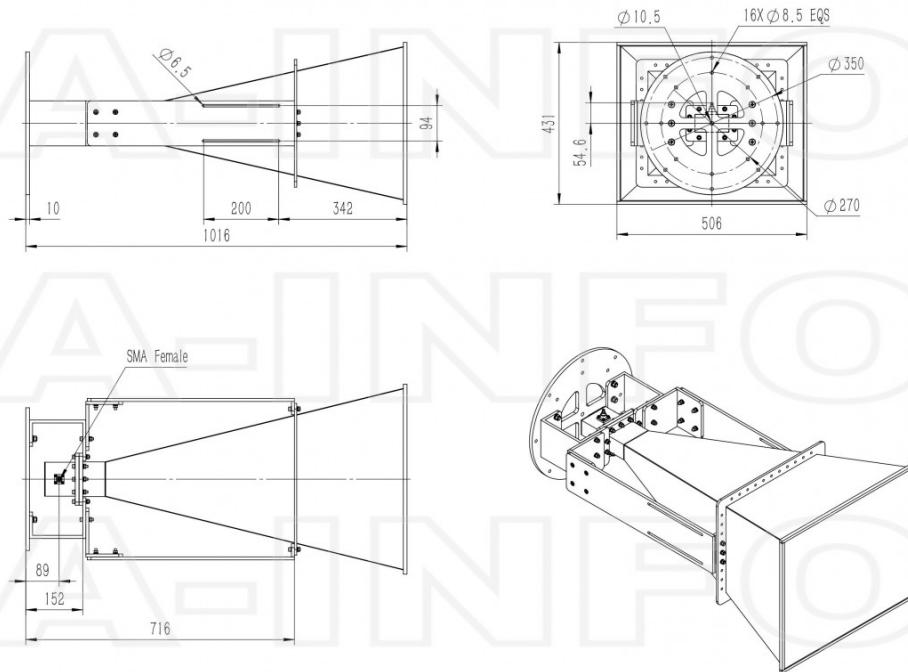

SMA Female Output with L Type Mounting Bracket & Radome (Option, P/N: LB-340-20-L2 & LB-340-20-C-SFSP0, Outdoor Application)

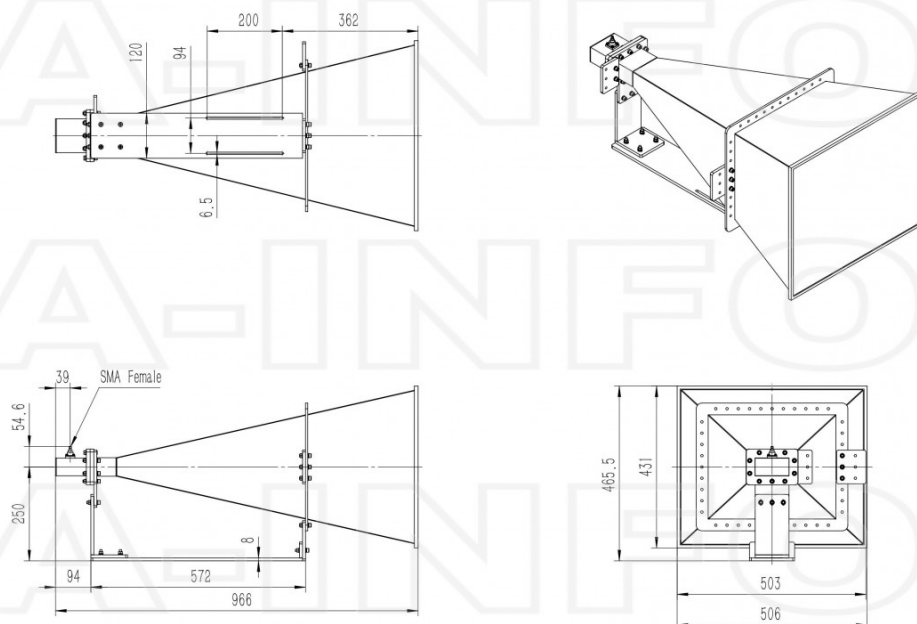

Typical Test Results

Gain

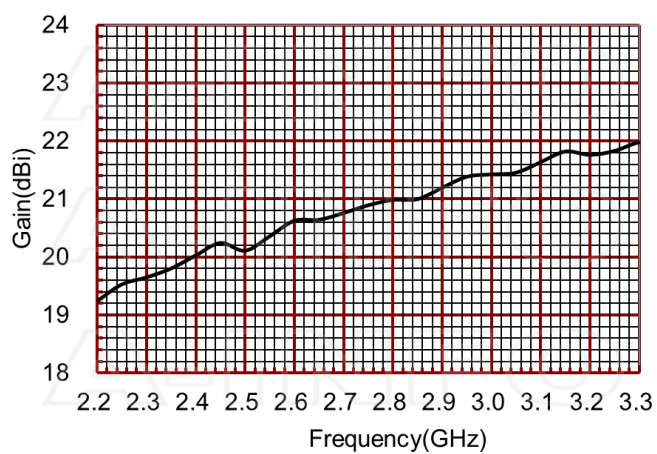

Antenna Factor

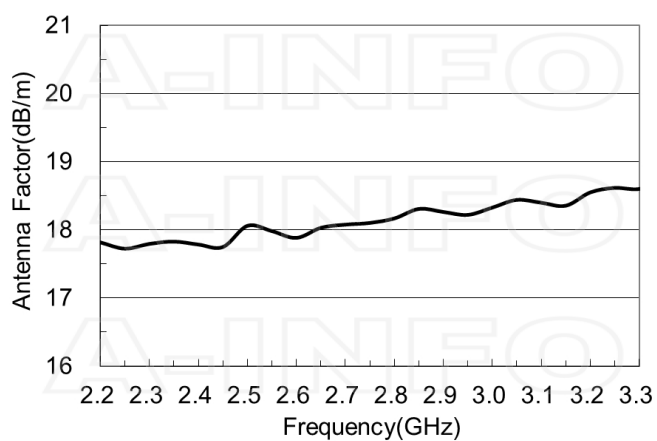

Antenna Factor (Table)

| Frequency(GHz) | Gain(dBi) | Antenna Factor(dB/m) |
|----------------|-----------|----------------------|
| 2.2 | 19.24 | 17.82 |
| 2.3 | 19.65 | 17.80 |
| 2.4 | 20.03 | 17.79 |
| 2.5 | 20.11 | 18.06 |
| 2.6 | 20.63 | 17.88 |
| 2.7 | 20.76 | 18.08 |
| 2.8 | 20.98 | 18.17 |
| 2.9 | 21.19 | 18.26 |
| 3.0 | 21.42 | 18.33 |
| 3.1 | 21.64 | 18.40 |
| 3.2 | 21.76 | 18.55 |
| 3.3 | 21.98 | 18.60 |

VSWR

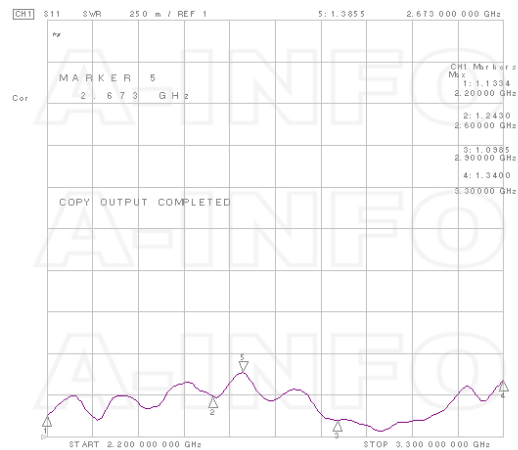

Pattern

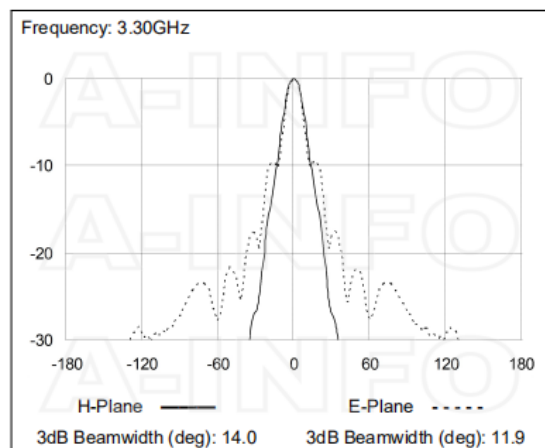
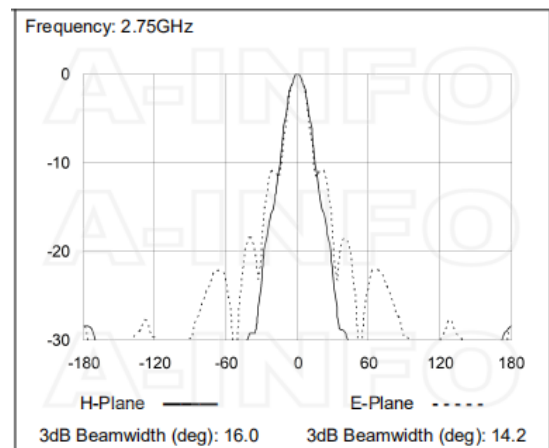
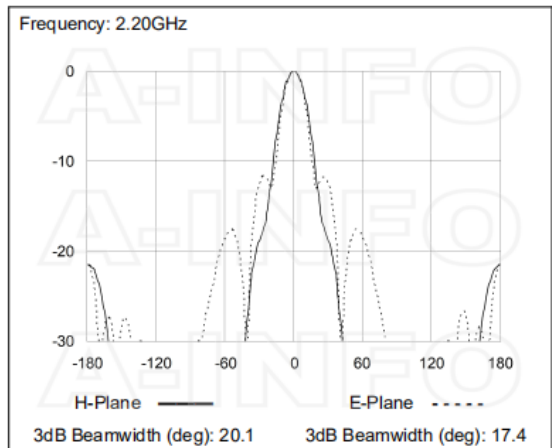

Related Products



LB-340-20-MB2 Round Type Mounting Bracket



LB-340-20-L2 L type mounting bracket



Carrying Case_LB-340-20-C AI Alloy Carrying Case



SM-SM-A050-1000 Flexible Cable Assembly 1000mm DC- 26.5GHz SMA Male to SMA Male



SM-SM-A050-1500 Flexible Cable Assembly 1500mm DC- 26.5GHz SMA Male to SMA Male



SM-SM-A050-2000 Flexible Cable Assembly 2000mm DC- 26.5GHz SMA Male to SMA Male



SM-SM-A050-3000 Flexible Cable Assembly 3000mm DC- 26.5GHz SMA Male to SMA Male



SM-SM-A050-5000 Flexible Cable Assembly 5000mm DC- 26.5GHz SMA Male to SMA Male



SM-SM-A050-10000 Flexible Cable Assembly 10000mm DC- 26.5GHz SMA Male to SMA Male



SM-SM-A080-200 Flexible Cable Assembly 200mm DC- 26.5GHz SMA Male to SMA Male



SM-SM-A080-300 Flexible Cable Assembly 300mm DC- 26.5GHz SMA Male to SMA Male



SM-SM-A080-500 Flexible Cable Assembly 500mm DC- 26.5GHz SMA Male to SMA Male



SM-SM-A080-1000 Flexible Cable Assembly 1000mm DC- 26.5GHz SMA Male to SMA Male



SM-SM-A080-1500 Flexible Cable Assembly 1500mm DC- 26.5GHz SMA Male to SMA Male



SM-SM-A080-2000 Flexible Cable Assembly 2000mm DC- 26.5GHz SMA Male to SMA Male



SM-SM-A080-3000 Flexible Cable Assembly 3000mm DC- 26.5GHz SMA Male to SMA Male



SM-SM-A080-5000 Flexible Cable Assembly 5000mm DC- 26.5GHz SMA Male to SMA Male



SM-SM-A080-10000 Flexible Cable Assembly 10000mm DC- 26.5GHz SMA Male to SMA Male



SM-SM-A080-20000 Flexible Cable Assembly 20000mm DC- 26.5GHz SMA Male to SMA Male



SM-SM-A100-100 Flexible Cable Assembly 100mm DC- 18GHz SMA Male to SMA Male



SM-SM-A100-200 Flexible Cable Assembly 200mm DC- 18GHz SMA Male to SMA Male



SM-SM-A100-300 Flexible Cable Assembly 300mm DC- 18GHz SMA Male to SMA Male



SM-SM-A100-500 Flexible Cable Assembly 500mm DC- 18GHz SMA Male to SMA Male



SM-SM-A100-1000 Flexible Cable Assembly 1000mm DC- 18GHz SMA Male to SMA Male



SM-SM-A100-1500 Flexible Cable Assembly 1500mm DC- 18GHz SMA Male to SMA Male



SM-SM-A100-2000 Flexible Cable Assembly 2000mm DC- 18GHz SMA Male to SMA Male



SM-SM-A100-3000 Flexible Cable Assembly 3000mm DC- 18GHz SMA Male to SMA Male



SM-SM-A100-5000 Flexible Cable Assembly 5000mm DC- 18GHz SMA Male to SMA Male



SM-SM-A100-10000 Flexible Cable Assembly 10000mm DC- 18GHz SMA Male to SMA Male

Similar Products



LB-340-20-A Standard Gain Horn Antenna 2.2-3.3GHz 20dB Gain Rectangular Waveguide Interface



LB-340-20-ASPO Standard Gain Horn Antenna 2.2-3.3GHz 20dB Gain Rectangular Waveguide Interface



LB-340-20-C-NF Standard Gain Horn Antenna 2.2-3.3GHz 20dB Gain N Type Female

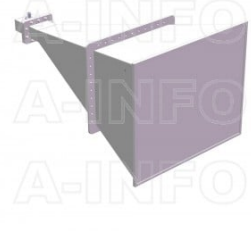

LB-340-20-C-NFSPO Standard Gain Horn Antenna 2.2-3.3GHz 20dB Gain N Type Female



LB-340-20-C-SF Standard Gain Horn Antenna 2.2-3.3GHz 20dB Gain SMA Female

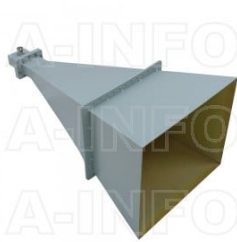

LB-340-20-C-7/16F Standard Gain Horn Antenna 2.2-3.3GHz 20dB Gain 7/16(DIN) Female

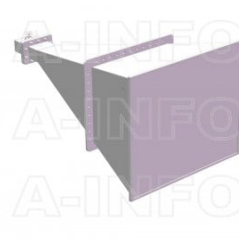

LB-340-20-C-7/16FSP Standard Gain Horn Antenna 2.2-3.3GHz 20dB Gain 7/16(DIN) Female

About this Datasheet

• Product Information

Product Link:

<https://www.ainfoinc.com/lb-340-20-c-sfsfo-standard-gain-horn-antenna-2-2-3-3-ghz-20db-gain-sma-female>
Data subject to change without notice.

© A-INFO INC. 2023. All Rights Reserved

• Contact Us

Address:dd

60 Tesla, Irvine, CA 92618, USA

Website:

www.ainfoinc.com

Email:

sales@ainfoinc.com

• Phone & Fax

Phone:

+1-949-639-9688
+1-949-639-9608

Fax:

+1-949-639-9670